

# STANDARD DESIGN DEPRESSED GUTTER DETAIL

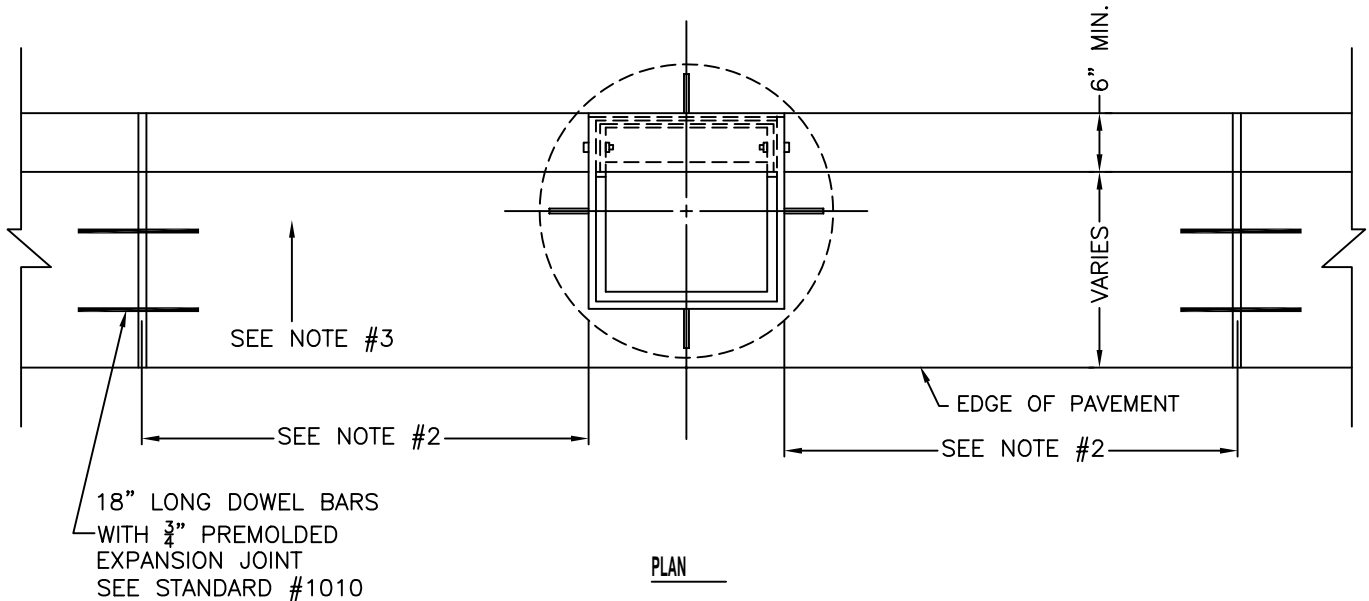

18" LONG DOWEL BARS  
WITH 3/4" PREMOLDED  
EXPANSION JOINT  
SEE STANDARD #1010

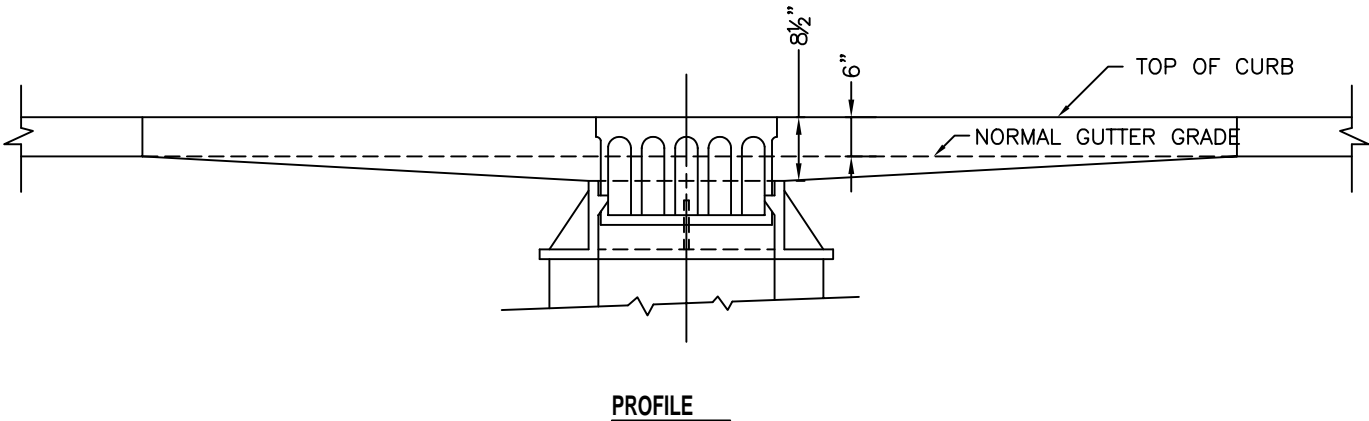

**NOTES:**

1. THE GUTTER FLOW LINE GRADE SHALL BE DEPRESSED TO MATCH FLOW LINE AT ALL INLETS AND CATCH BASINS UNLESS OTHERWISE SPECIFIED ON PLANS.
2. 3' MIN. FOR P.C.C. PAVEMENT, 5' MIN. FOR FLEXIBLE PAVEMENT, THIS DIMENSION SHALL BE ADJUSTED TO ALIGN WITH JOINTS ON ADJACENT PCC PAVEMENT.
3. THE BOTTOM SLOPE OF COMBINATION CURB AND GUTTER CONSTRUCTED SHALL BE THE SAME SLOPE AS THE SUB BASE OR 6% WHEN SUB BASE IS OMITTED.

CITY OF DECATUR, ILLINOIS DEPARTMENT OF ENGINEERING & INFRASTRUCTURE	ISSUED: 7-3-78	
	REVISIONS	BY   DATE
ADOPTED JANUARY 1, 2003   DIRECTOR OF ENGINEERING & INFRASTRUCTURE	F.W.T.	12/15/81
	SHOE	9/15/89
	JMM	5/1/02

STANDARD# 3091

K:\CVC\Engineer\eng-data\AUTOCAD\STANDARD\Standards 2003\Std#3091.dwg\Wed, 30 Apr 2003 - 10:55am