

STANDARD DESIGN GRATE, TYPE 8

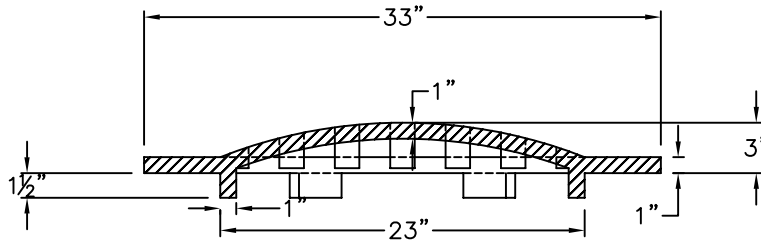
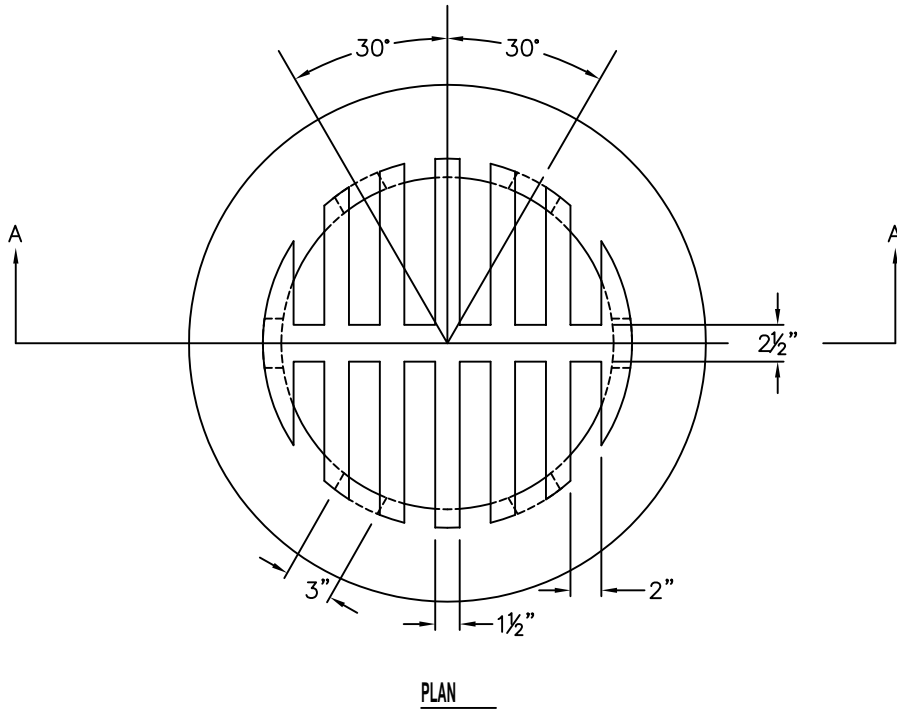

SECTION A-A

NOTES:

1. THE CAST GRATE MAY BE MADE OF EITHER GRAY IRON OR DUCTILE IRON.
2. DUCTILE IRON CASTING SHALL BE GRADED 65-45-12.
3. WEIGHT = 200 LBS.
4. TO BE USED IN PAVED AREA ONLY.

CITY OF DECATUR, ILLINOIS
DEPARTMENT OF ENGINEERING
& INFRASTRUCTURE

ADOPTED JANUARY 1, 2003

DIRECTOR OF ENGINEERING & INFRASTRUCTURE

ISSUED: 7-3-78	
REVISIONS	
BY	DATE
F.W.T.	12/15/81
SHOE	9/15/89
JMM	5/1/02

STANDARD# 3043

K:\CVC\Engineer\eng-data\AUTOCAD\STANDARD\Standards 2003\Std3043.dwg\Wed, 30 Apr 2003 - 10:46am