

STANDARD DESIGN CONCRETE CURB TYPE B FLEXIBLE PAVEMENT

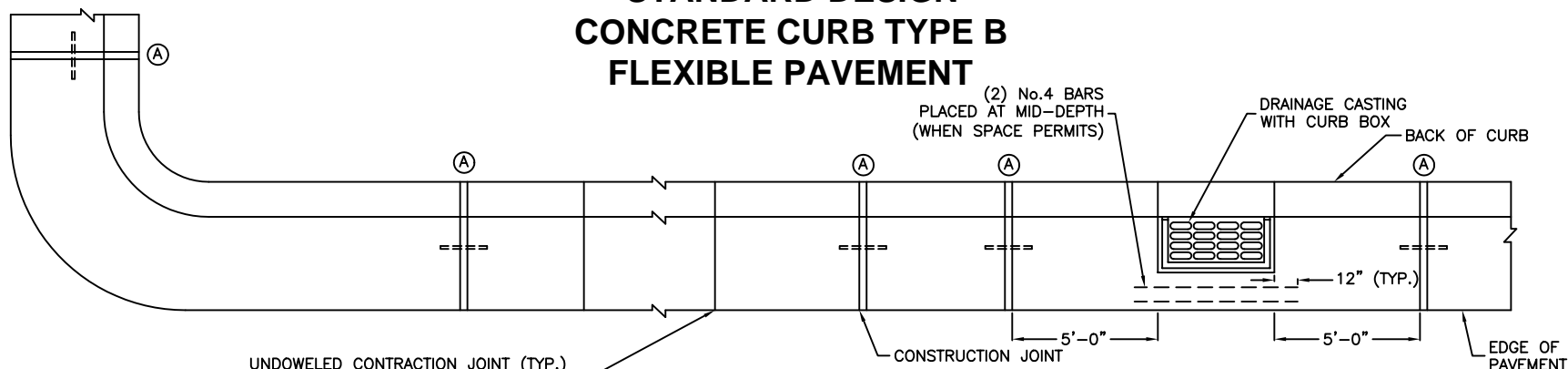

- UNDOWELED CONTRACTION JOINT (TYP.)
CONSTRUCTION OPTION:
1. FORM WITH $\frac{1}{8}$ " THICK STEEL TEMPLATE 2" DEEP, AND SEAL.
 2. SAW 2" DEEP AT 4 TO 24 HOURS, AND SEAL.
 3. INSERT $\frac{3}{4}$ " THICK PREFORMED JOINT FILLER FULL DEPTH & WIDTH.

ADJACENT TO FLEXIBLE PAVEMENT

PLAN

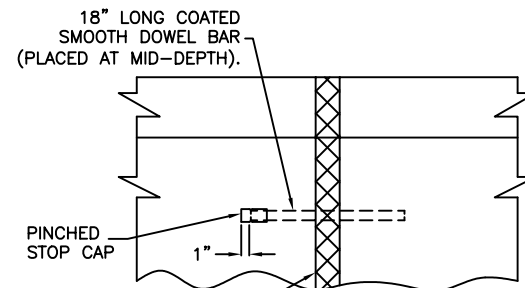

FULL DEPTH & WIDTH 1" THICK (MIN.)
PREFORMED EXPANSION JOINT FILLER.

DETAIL (A) EXPANSION JOINT

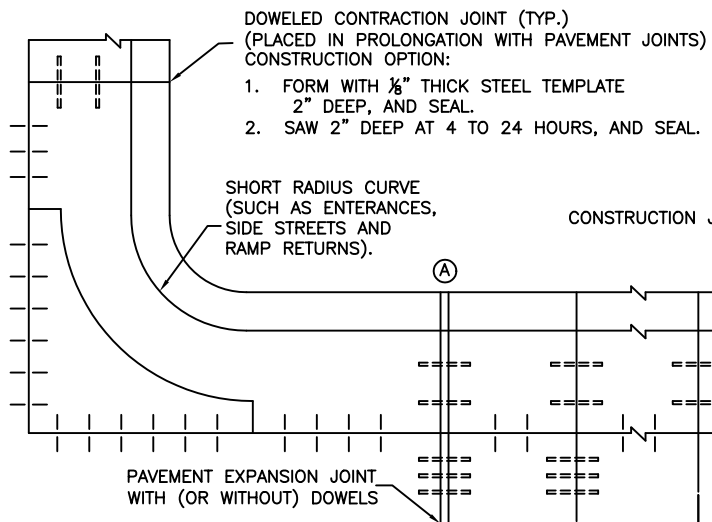

- DOWELED CONTRACTION JOINT (TYP.)
(PLACED IN PROLONGATION WITH PAVEMENT JOINTS)
CONSTRUCTION OPTION:
1. FORM WITH $\frac{1}{8}$ " THICK STEEL TEMPLATE 2" DEEP, AND SEAL.
 2. SAW 2" DEEP AT 4 TO 24 HOURS, AND SEAL.

ADJACENT TO PCC PAVEMENT OR PCC BASE COURSE

PLAN

CITY OF DECATUR, ILLINOIS
DEPARTMENT OF ENGINEERING
& INFRASTRUCTURE

ADOPTED JANUARY 1, 2003

DIRECTOR OF ENGINEERING & INFRASTRUCTURE

ISSUED: 1/1/03	
REVISIONS	
BY	DATE
KSG	10/2002

STANDARD # 1010
SHEET #2 OF 2